



Corporate: 425 Hoover St NE - Minneapolis, MN 55413

PH: 612-331-1776 www.duncanco.com

Appleton, WI

PH: 920-739-6066 www.gwssupply.com

VALVES · CONTROLS · INSTRUMENTS · FILTRATION

PROCESS SAFETY SPECIALTIES · VALVE AUTOMATION



Minneapolis, MN

PH: 612-861-1749

Appleton, WI

PH: 920-462-4700

www.arjaynet.com

## PULP MILL VALVE SOLUTIONS

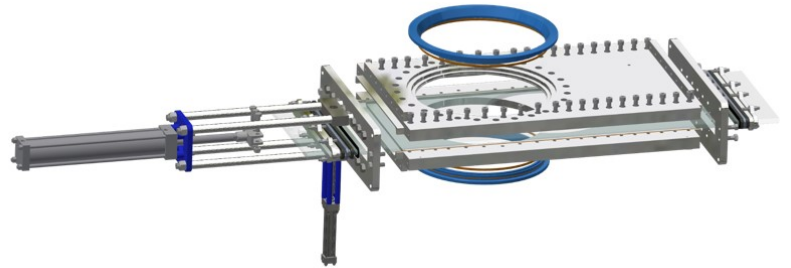

### DIGESTER CAPPING VALVES

- ◆ Custom o-port knife gate with zero leak bubble tight shut-off
- ◆ Increased efficiency in both fill rate and digester capacity
- ◆ HT65 & HT1600 hardening for significantly increased wear resistance
- ◆ Fully repairable valve with replaceable seats; completely machined and bolted for easy maintenance

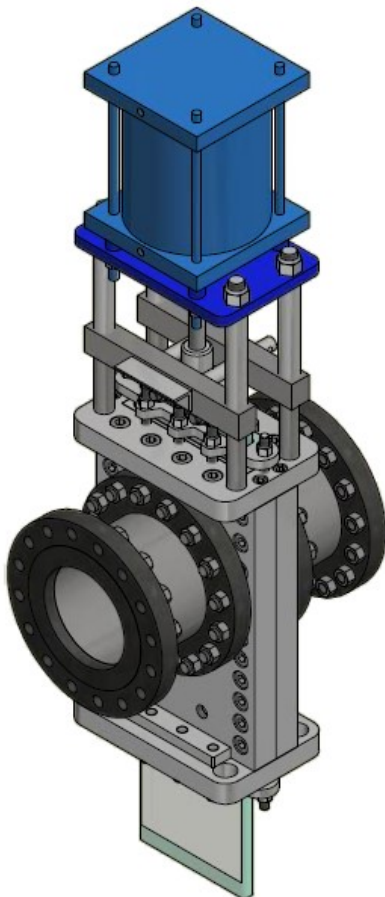

### DIGESTER BLOW VALVE

- ◆ Drop in replacement for existing ball valves with same face to face takeout
- ◆ Completely machined and bolted
  - No welding for easy maintenance
- ◆ Can easily be repaired on-site
  - Limited time shut down needed in critical situations
- ◆ Bi-directional with renewable seats
  - Cost savings vs. replacement
- ◆ Gate is Duplex 2205 with HT-1600
  - No metal fatigue and will not gall surface
- ◆ Seat material is anti-abrasion Tru-Hard 66
  - No cold flow with temperature fluctuations



Corporate: 425 Hoover St NE - Minneapolis, MN 55413  
 PH: 612-331-1776 www.duncanco.com  
 Appleton, WI  
 PH: 920-739-6066 www.gwssupply.com

VALVES · CONTROLS · INSTRUMENTS · FILTRATION  
 PROCESS SAFETY SPECIALTIES · VALVE AUTOMATION



Minneapolis, MN  
 PH: 612-861-1749  
 Appleton, WI  
 PH: 920-462-4700  
 www.arjaynet.com

## PULP MILL VALVE SOLUTIONS

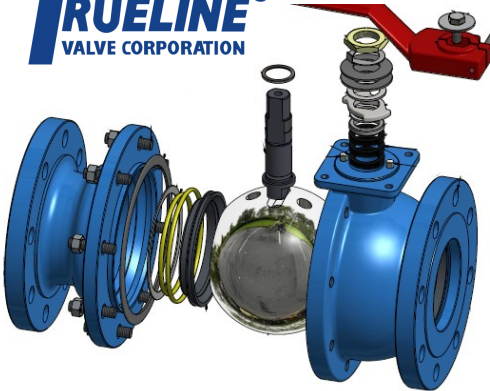

### METAL SEATED BALL VALVES

- ◆ Reliable isolation in liquor applications
- ◆ HT65 hardened dual scrapers on to prevent build up
- ◆ Sealed cavity to prevent debris from entering behind the seats



### CONTROL VALVES

- ◆ Quarter-turn operation with equal percentage flow characteristic
- ◆ Superior to v-ball control, similar to globe style control valve rangeability
- ◆ Noise attenuation and cavitation reductions in a quarter-turn valve



### ISOLATION VALVES

- ◆ Bubble tight zero leak isolation
- ◆ Available in lug, double flanged, and flanged gate valve face to face
- ◆ Optional sealed bearing design for specific applications - references available